

Driveway Widening (hatched area) in order to protect existing trees the driveway should be constructed according to recommendations of Clive Leaskie, Arborist of Huleaf Tree Services Report of 2.12.2013.

1. Utilise a holding approach. The existing grade should be used as the base.
2. Create the layer
3. Then 40mm of coarse grade crushed rock followed by 50mm of 20mm B grade crushed rock to ensure permeability
4. No works to occur beyond the required area for the driveway
5. No trenching, digging, or excavation to occur without the prior consent of an arborist
6. A suitable Tree Protection Fence to be erected before commencing work. Due to the minor nature of the proposed works, star pickets and danger tape

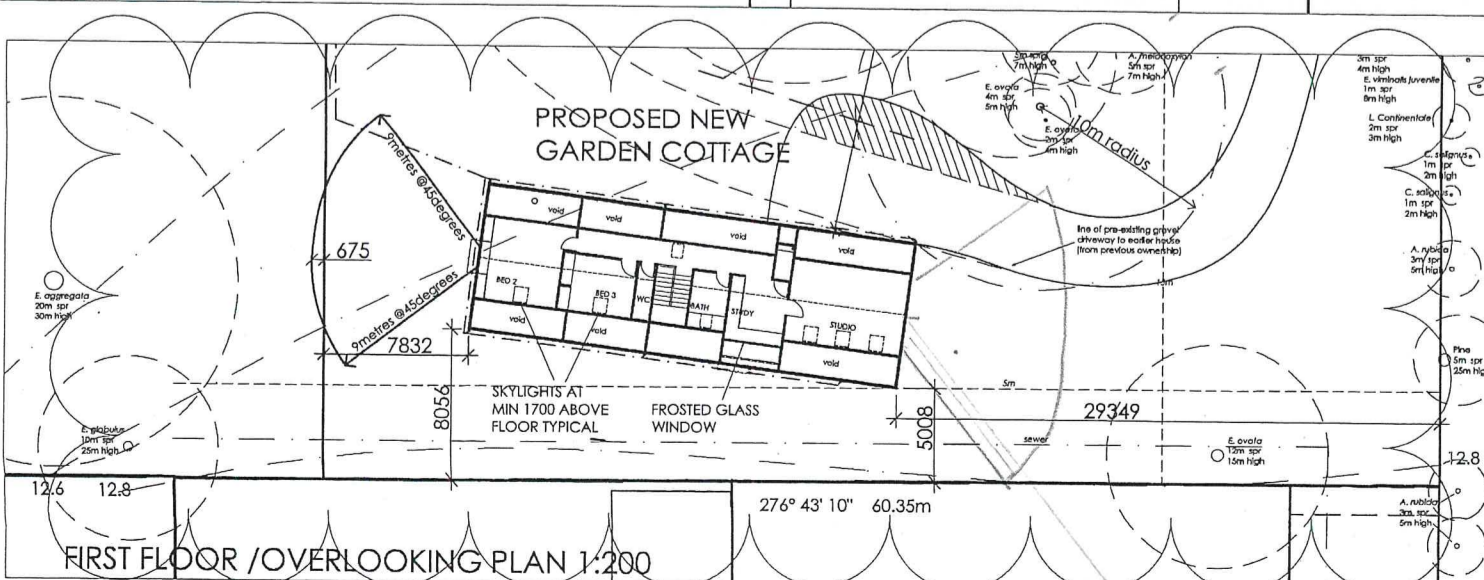

**MACEDON RANGES PLANNING SCHEME**  
**PLANNING PERMIT NO. PLN2018/5518**  
 26 AUG 2019  
 Date: 26 AUG 2019  
 Authorised Officer: [Signature]  
 Sheet 1 of 2

**LEVELS TO ARBITRARY DATUM**

THE CONTRACTOR SHALL CHECK ALL DIMENSIONS AND LEVELS ON SITE BEFORE COMMENCING WORK. FIGURED DIMENSIONS SHALL TAKE PREFERENCE OVER SCALED DIMENSIONS. DRAWING TO BE READ IN CONJUNCTION WITH THE SPECIFICATION AND OTHER DRAWINGS AND INSTRUCTIONS ISSUED BY THE ARCHITECT AND ENGINEER. REFER ANY DISCREPANCIES TO THE ARCHITECT. THE CONTENTS OF THIS DRAWING REMAIN THE COPYRIGHT OF THE ARCHITECT.

**PROJECT**  
 GARDEN COTTAGE  
 LOT 2 PS729990T 9 LADYE PLACE WOODEND

**DRG. TITLE**  
 TOWN PLANNING DRAWING  
 Site Plan and Overlooking Plan

**AMENDMENTS**

- a. 25m ovala and 3 lines of concrete partially included now removed; internal fence note; driveway construction details updated - 9/3/2018
- b. 25m ovala location confirmed - 16/3/2018
- c. single garage changed to double 5/9/18
- d. first floor added to existing roof space; with windows and skylights; Overlooking Plan added - 10/3/19
- e. fence shown 14.3.19

**DATE: 10.1.18** **SCALE: 1:200**

**BRUCE KIRKMAN ARCHITECT**  
 111 MARINER STREET  
 WILLIAMSTOWN 3016  
 TEL 0420 207425

**DRG. 17021P02e**