

Advertised

MACEDON RANGES SHIRE COUNCIL
 COPYRIGHT AND DISCLAIMER INFORMATION
 This copied document is made available for the sole purpose of enabling its use in the planning process under the Planning and Environment Act 1987.
 The document must not be used in any way which may breach any copyright.

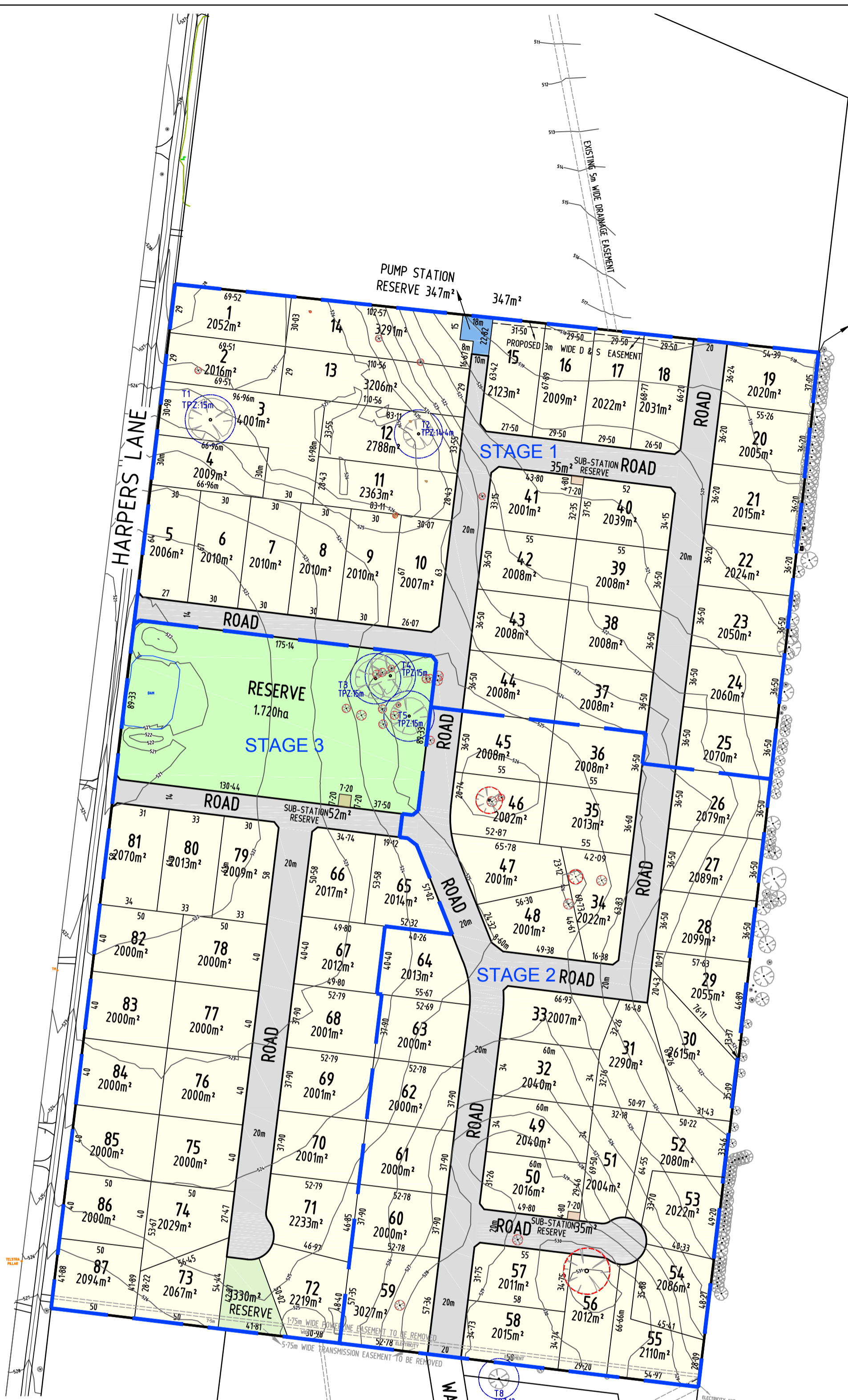

OVERALL AREA 23.84ha
 87 Lots @ 2114m² average

- TREE TO BE REMOVED
- TPZ: TREE PROTECTION ZONE
- TREE TO BE RETAINED
- SUB STATION RESERVE
- STAGE BOUNDARY

DIMENSIONS HEREON ARE SUBJECT TO SURVEY.
 THIS PLAN IS SUBJECT TO THE APPROVAL OF VARIOUS STATUTORY AUTHORITIES.
 CONTOURS SHOWN HEREON HAVE BEEN INTERPOLATED FROM ON-SITE LEVELS TAKEN IN METRES AND DECIMALS TO THE AUSTRALIAN HEIGHT DATUM ON 21/02/2020.
 CONTOUR VERTICAL INTERVAL METRES.
 IMPLIED EASEMENTS UNDER SECTION 12 (2) OF THE SUBDIVISION ACT 1988 TO APPLY TO ALL OF THE LAND IN THE PLAN.

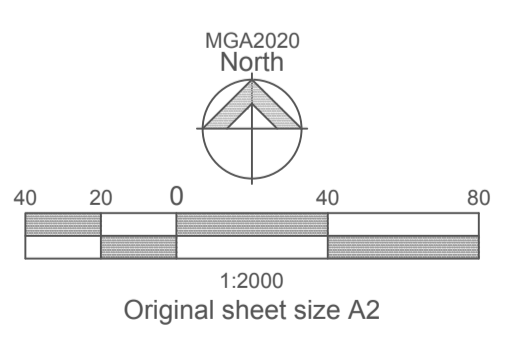

No.	Revision Description	Drawn	App'd	Date
3	Variation to lots 52-55	ME		Oct 2020
2	Stage boundary rectified	AHW	ME	Sep 2020
1	Prepared for town planning purposes	AHW	ME	14.07.2020

Millar & Merrigan authorize the use of this drawing only for the purpose described by the status stamp shown below. This drawing should be read in conjunction with all relevant contracts, specifications, reports & drawings.
 © Millar & Merrigan Pty. Ltd.

Millar | Merrigan

Civil Engineering
 Land Surveying
 Landscape Architecture
 Project Management
 Town Planning
 Urban Design
 Land Development Consultants

Millar & Merrigan Pty Ltd ACN 005 541 668
 Metro 2/126 Merrindale Drive, Croydon 3136
 Regional 156 Commercial Road, Morwell 3840
 Mail PO Box 247 Croydon, Victoria 3136
 M(03) 8720 9500 R(03) 5134 8611
 www.millarmerrigan.com.au
 survey@millarmerrigan.com.au

85 Harpers Lane, Kyneton
 Macedon Ranges Shire Council

25247P2
 VERSION 3
 SHEET 1 OF 1

FOR APPROVAL

PROPOSED SUBDIVISION PLAN